

MICA-TEC



SOLID PHENOLIC TOILET PARTITION CATALOG

Mica-tec

Solid phenolic

This is a unique material designed especially for water contact. It is perfect for areas with high humidity and hose down cleaning. The superior strength of solid phenolic offers many advantages over other materials. Its hard surface resists damage better, and it exceeds the Fire Protection Association recommendation for smoke production. Available in Arborite designer colors, patterns and wood grain textures.

SOLID PHENOLIC TOILET ENCLOSURES

MATERIALS: Solid phenolic with melamine surface both sides produced with resin impregnated materials compressed at pressures exceeding 1000 p.s.i. at 256 degrees Fahrenheit resulting in a solid, dense, water resistant product. All edges to be black.

THICKNESS: Doors..... Finished thickness to ¾" (19.05mm)
Panels..... Finished thickness to ½" (12.7mm)
Pilasters..... Finished thickness to ¾" (19.05mm)

CONSTRUCTION:

Doors and Panels:

Doors and partitions are manufactured from solid phenolic materials. Laminating to a core material is not an acceptable alternative. All edges are beveled and polished. Phenolic is Class-B fire rated based on E-84 Tunnel testing; NFPA No. 255 and U.L. No. 723.

Pilasters:

Pilasters are manufactured from solid phenolic materials. Laminating to a core material is not an acceptable alternative. All edges are beveled and polished. Phenolic is Class-B fire rated based on E-84 Tunnel testing; NFPA No. 255 and U.L. No. 723. Pilasters are to be secured to concrete floor with type 304 stainless steel floor mounting clips. All pilasters will have a 3" (76.2) high #4 finish stainless steel plinth (type 304) and have straight, flat sides to match pilaster profile. Anodized aluminum headrail, .050" (1.27) wall thickness, with anti-grip profile, will brace the top of the pilasters.

FITTINGS:

Wall and pilaster brackets are 13 gauge type 304 stainless steel. All connections must be with 1-ear or 2-ear brackets.

HARDWARE:

Each compartment will be complete with all stainless steel surface mounted hardware including; door hinges, latch, stop and keeper, coat hook, as well as all the necessary fittings and fastenings for a complete installation. Fasteners are chrome-plated brass through bolts with tamper-proof Torx-Pin heads. Door hinges to be surface mounted and through-bolt attached to doors and pilasters. Hinge material to be 12 gauge 304 stainless steel with bearing angles of 16 gauge 304 stainless to be electrically welded to full length of both leaves of the top and bottom hinge assemblies to prevent door sag. Fully adjustable door positioning cam and pintle to be made from nylon with a stainless steel pin encased in nylon. Pin must be held in position with snap ring design. Strike & keeper to be 12 gauge 304 stainless steel. Coat hook & bumper to be 304 stainless steel

ARBORITE® SOLID PHENOLIC CORE PANELS

General

Arborite® Solid Grade laminate is a high pressure solid composite designed for laboratory work surfaces, fume hood decks, fume hood liner panels, pegboards (drying racks), reagent racks, commercial countertops, cabinet drawer fronts, locker drawers, shelving, window sills and toilet partitions, and decorative casework components. Solid phenolic panels provide exceptional chemical and stain resistance combined with superior physical characteristics.

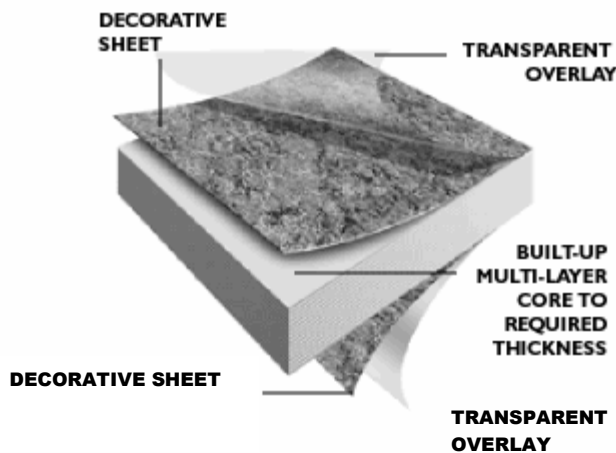

Three categories of Solid Phenolic Core Panels include:

- 1) **Arborite® Classic Grade** – represent a category of thick, self-supporting homogeneous panels finished with melamine surfaces on both sides. Can be used for laboratory applications and casework where less harmful acids and other chemical products are used.
- 2) **Arborite® Laboratory Grade** - represent a category of thick, self-supporting homogeneous panels finished with melamine surfaces on both sides. They are engineered to resist a variety of acids, solvents, general reagents and cleaning agents.
- 3) **Arborite® Fire rated solid phenolic core panels** – Arborite® high pressure laminate with fire retardant properties are suitable for applications where fire retardant properties are required by building codes, i.e., elevator cabs, stairwells, public areas, and hospitals. This laminate is also suitable for all segments within the transportation industry.

Solid phenolic core panels (material specifications)

- Decorative surfaces on both sides
- Non-asbestos
- Chemical and stain resistant (see list of chemicals and stains below)
- Non-porous
- Does not promote growth of common bacteria
- Durable and strong
- Resists corrosion
- Meets or exceeds performance standards set by NEMA LD3-2000 for Compact Laminate grade (CGS)
- Resistant to impact and stress cracking

Chemical Resistance Properties

For further information regarding Arborite® chemical resistance properties for Solid Phenolic panels, please see list of chemicals below for both categories: **Arborite® Laboratory Grade and Arborite® Classic Grade.**

ARBORITE® CLASSIC GRADE - Chemical Reagent Staining Effect

Acetic Acid (all concentrations).....	SL/E	Methyl Methacrylate	NE
Acetone	SL/E	Methyl Orange	NE
Ag Eosin Bluish 5% in Alcohol.....	NE	Methyl Red.....	NE
Alconox	NE	Mineral Oil.....	NE
Aluminon	NE	Monsel's Solution	NE
Ammonium Hydroxide (all concentrations).....	NE	Naphtha	NE
Ammonium Phosphate.....	NE	Naphtalene	NE
Amyl Acetate	SL/E	n-Hexane	NE
Amyl Alcohol	SL/E	Nigrosine	NE
Aqua Regia	SE	Nitric Acid (all concentrations).....	SE
Aromatic Ammonia	NE	Perchloric Acid (concentrated).....	SE
Benedict's Solution.....	NE	Petroleum Jelly.....	NE
Bromothymol Blue	NE	Phenol (all concentrations).....	NE
Butyl Alcohol.....	SL/E	Phenolphthalein.....	NE
Calcium Hypochlorite (concentrated)	NE	Phosphate Buffered Saline	NE
Camphorated para-chlorophenol.....	NE	Phosphoric Acid (all concentrations)	SE
Carbon Disulfide.....	SL/E	Picric Acid 1.2% (0.05M)	SE
Carbon Tetrachloride	SL/E	Pine Oil	NE
Cellosolve	NE	Potassium Permanganate.....	SE
Chlorobenzene	NE	Povidone Iodine	NE
Chloroform	NE	Procaine.....	NE
Chromic Trioxide.....	SE	Quaternary Ammonia Compounds.....	NE
Copper Sulfate	NE	Safranin O	NE
Cresol.....	NE	Silver Nitrate	SE
Cresol Red	NE	Sodium Azide.....	NE
Crystal Violet.....	NE	Sodium Chromate.....	NE
Dimethyl Formamide.....	NE	Sodium Hydroxide (all concentrations).....	ME
Dioxane.....	NE	Sodium Hypochlorite 5%.....	SL/E
EDTA.....	NE	Sodium Sulfide 15%.....	NE
Ethyl Acetate.....	SL/E	Sulfuric Acid (all concentrations)	SE
Ethyl Alcohol.....	NE	Sodium Thiocyanate	NE
Ethylene Glycol	NE	Sucrose 50%.....	NE
Eucalyptol	NE	Sudan III.....	NE
Formaldehyde	SL/E	Tannic Acid (sat.).....	SL/E
Formalin.....	SL/E	Tetrahydrofuran.....	NE
Formic Acid (all concentrations)	SE	Thymol & Alcohol	NE
Gasoline	NE	Thymol Blue	NE
Gentian Violet.....	ME	Tincture of Iodine.....	NE
Glacial Acetic Acid, 99% (concentrated).....	SL/E	Tincture of Mercurochrome	NE
Gram Stains	NE	Tincture of Merthiolate	NE
Hydrofluoric Acid 48% (concentrated).....	SE	Toluene	NE
Hydrochloric Acid (all concentrations).....	SE	Trichlorethane	NE
Hydrogen Peroxide 3%.....	NE	Trisodium Phosphate 30%.....	NE
Iodine.....	NE	Urea.....	NE
Karl Fischer Reagent.....	NE	Uric Acid (sat.).....	SL/E
Kerosene	NE	Vegetable Oils.....	NE
Lactated Ringers Solution.....	NE	Water.....	NE
Lysol™	NE	Wright's Blood Stain.....	NE
Malachite Green.....	NE	Xylene.....	NE
Methanol.....	SL/E	Zephiran Chloride	NE
Methylene Blue.....	NE	Zinc Chloride	NE
Methylene Chloride	NE	Zinc Oxide Ointment.....	NE
Methyl Ethyl Ketone.....	NE		

Test procedure: Listed materials were placed in contact with Arborite® Classic Grade surface under 1" (25.4mm) diameter watch cover glass for 16-24 hours duration prior to evaluation for effect. The effects of staining are color and pattern dependent.

Explanation of test results:

NE: No effect

SL/E: Slight effect

ME: Moderate effect

SE: Severe effect

Results may vary slightly by color. Request a sample for evaluation and chemical resistance testing. It is recommended that chemical spills be cleaned immediately to prevent or greatly reduce the effects caused by longer exposure.

Arborite® Laboratory Grade - Chemical Reagent Staining Effect

Acids:

Acetic Acid (all concentrations)
Aqua Regia **
Chromic Trioxide (Chromic Acid Cleaning Solution)*
Formic Acid (all concentrations) *
Glacial Acetic Acid 99% (concentrated)
Hydrochloric Acid (all concentrations)
Hydrofluoric Acid 48% (concentrated) *
Nitric Acid (all concentrations) **
Perchloric Acid (concentrated)
Phosphoric Acid (all concentrations)
Picric Acid 1.2% (0.05M)
Sulfuric Acid (all concentrations) **
Tannic Acid (sat.)
Uric Acid (sat.)

Solvents:

Acetone
Amyl Acetate
Amyl Alcohol
Butyl Alcohol
Carbon Disulfide
Carbon Tetrachloride
Chlorobenzene
Chloroform
Cresol
Dimethyl formamide
Dioxane
EDTA
Ethyl Acetate
Ethyl Alcohol
Formaldehyde
Methanol
Methyl Ethyl Ketone
Methylene Chloride
Naphthalene
n-Hexane
Phenol (all concentrations)*
Tetrahydrofuran
Toluene
Trichloroethane
Xylene

Bases:

Ammonium Hydroxide (all concentrations)
Sodium Hydroxide (all concentrations) **
Sodium Sulfide 15%

General Reagents:

Alconox (Lab. Detergent)
Aluminon
Ammonium Phosphate
Aromatic Ammonia
Benedict's Solution
Blood
Calcium Hypochlorite (concentrated)
Camphorated para-chlorophenol *
Cellosolve
Coffee, black
Copper Sulfate
Ether, 1:20
Ethylene Glycol
Eucalyptol
Formalin
Gasoline
Hydrogen Peroxide 3%

Iodine
Karl Fisher Reagent
Kerosene
Lactated Ringers
Lysol™
Methyl Methacrylate
Milk, homogenized
Mineral Oil
Monsel's Solution (Ferric Subsulfate)
Naphtha
Orange juice
Petroleum Jelly
Phosphate Buffered Saline (PBS)
Pine Oil
Potassium Permanganate
Povidone Iodine
Procaine
Quaternary Ammonia Compounds
Silver Nitrate
Sodium Azide
Sodium Chromate
Sodium Hypochlorite 5%
Sodium Thiocyanate
Sucrose 50%
Thymol & Alcohol
Tide™
Tincture of Iodine
Tincture of Mercurochrome
Tincture of Merthiolate
Trisodium Phosphate 30%
Urea
Vegetable Oil
Vinegar
Water
Zephiran Chloride
Zinc Chloride
Zinc Oxide Ointment

Stains and Indicators:

Ag Eosin Bluish 5% in Alcohol
Bromothymol Blue
Cresol Red
Crystal Violet
Gentian Violet 1%
Gram Stains
Malachite Green
Methyl Orange
Methyl Red
Methylene Blue
Nigrosine (India Ink)
Phenolphthalein
Safranin O
Sudan III
Thymol Blue
Wright's Blood St

Test procedure: Listed materials were placed in contact with Arborite® Laboratory Grade surface under 1" (25.4mm) diameter watch cover glass for 16-24 hours duration prior to evaluation for effect. The effects of staining are color and pattern dependent. Request a sample for evaluation and chemical resistance testing

* Causes slight change of gloss or color.

**Causes slight damage, with degree of damage proportionate to length of exposure and concentration.

Other items leave no effect

Arborite® Fire rated solid phenolic core panels

Arborite® high pressure laminate with fire retardant properties are suitable for applications that require a Class A / Class I product.

Certifications - SOLID PHENOLIC Fire Retardant (1/4" – 1 1/4")

- UL
- Class 1

The basic standard to investigate products in this category is UL723, "Test for Surface Burning Characteristics of Building Materials"

Performance Properties:

Flame spread : 25
Smoke developed: 200

Available Surface Textures for Arborite® Classic Grade and Fire rated solid phenolic core panels

- 1) *Cashmere* – a fine texture with a slight sheen
- 2) *Diamond* – a fine beaded texture which minimizes smudges, finger marks and offers optimum scratch resistance
- 3) *Gloss* *– a flat texture with a high sheen
- 4) *Laqwood* – a slightly embossed woodgrain texture
- 5) *Velvutex* – a smooth furniture finish texture

TEXTURES	SURFACE GLOSS VALUE *
Cashmere – a fine, matte texture with a slight sheen	8-12
Diamond – a fine beaded texture which minimizes smudges, finger marks and offers optimum scratch resistance.	10-16
Gloss – a flat texture with a high sheen	19-24
Laqwood – a slightly embossed woodgrain texture	20-30
Velvutex – a smooth furniture finish texture	10-20

* CAN3-A172-M79

Available Surface Textures for Arborite® Laboratory Grade solid phenolic core panels

- 1) *Matte* - fine, matte texture with a slight sheen
- 2) *Diamond* – a fine beaded texture which minimizes smudges and finger marks.

Standard Panel Sizes for Solid Phenolic Core Panels:

IMPERIAL MEASURE (FEET)	METRIC MEASURE (MM)
4' x 8'	1220 mm x 2440 mm
4' x 10'	1220 mm x 3050 mm
5' x 8'	1525 mm x 2440 mm
5' x 10'	1525 mm x 3050 mm
5' x 12'	1525 mm x 3660 mm

* Gloss Surface Texture is only available in 4' x 8', 4' x 10', 5' x 12' (guaranteed good one side only)

Nominal Panel Thickness* Solid Phenolic Core Panels:

Imperial Measure (In.)	Metric Measure (Mm)	Thickness Tolerance	Lbs/Sq.Ft
1/8"	3.2 mm	± 0.012"	0.9
1/4"	6.4 mm	± 0.0125"	1.81
3/8"	9.6 mm	± 0.0187"	2.72
1/2"	12.7 mm	± 0.025"	3.62
5/8"	15.9 mm	± 0.0312"	4.53
3/4"	19.0 mm	± 0.037"	5.40
1"	25.4 mm	± 0.050"	7.24
1 ¼ "	32.0 mm	± 0.0625"	9.00

* thickness tolerance according to NEMA LD3-2000 for 2000 for Compact Laminate grade (CGS)

NEMA Performance Properties of Solid Phenolic Core Panels (CGS) - Arborite® meets or exceeds these values

ASTM TEST METHOD	NOMINAL THICKNESS	UNITS: MM / INCHES	COMPACT LAMINATE	
			>6.0 mm (>0.236")	2.0-6.0 mm (0.079" – 0.236")
D 790	Flexural Strength	MPa (psi) MD Min.	1.24 x 10 ² (18000)	1.24 x 10 ² (18000)
		MPa (psi) CD Min.	8.27 x 10 ¹ (12000)	8.27 x 10 ¹ (12000)
D 790	Flexural Modulus (Modulus of Elasticity)	MPa (psi) MD Min.	1.10 x 10 ⁴ (1.6 x 10 ⁶)	1.10 x 10 ⁴ (1.6 x 10 ⁶)
		MPa (psi) CD Min.	9.65 x 10 ³ (1.4 x 10 ⁶)	9.65 x 10 ³ (1.4 x 10 ⁶)
D 638	Tensile Strength	MPa (psi) MD Min.	1.24 x 10 ² (18000)	1.24 x 10 ² (18000)
		MPa (psi) CD Min.	8.27 x 10 ¹ (12000)	8.27 x 10 ¹ (12000)

**NEMA Performance Properties for ARBORITE® CLASSIC GRADE ONLY
(Arborite® meets or exceeds these values)**

PROPERTY	GRADE** UNITS	COMPACT LAMINATE	
		>6.0 mm (± 5% of thickness) >0.236" (± 5% of thickness)	2.0-6.0 mm (± 0.30 mm) 0.125" - 0.236" (± 0.012")
Light Resistance	Rating, * Min.	SL	SL
Cleanability	Rating, * Max.	20	20
Stain 1-10 Stain 11-15	Rating, * Min.	NE M	NE M
Boiling water resistance	Rating, * Min.	NE	NE
High Temperature Resistance	Rating, * Min.	SL	SL
Ball Impact Resistance	mm (in.) Min.	1900 (75)	1900 (75)
Radiant Heat Resistance	Sec., Min.	200	200
Dimensional Change	% MD, Max	0.3	0.3
	% CD, Max	0.7	0.7
Room Temperature Dimensional Stability	% MD, Max	0.3	0.3
	% CD, Max	0.7	0.7
Wear Resistance	Cycles, Min.	400	400

* Rating system: NE – no effect, SL – slight effect, M – moderate effect, S – Severe Effect

** Grade designations are not acronyms

Limitations: Arborite® Laboratory Grade and Arborite® Classic Grade panels offer special protection for all kinds of laboratory work surfaces. However, no one material is suitable for all possible conditions; its properties should be checked for suitability under the specific conditions of each installation. The information provided herein is not intended for or to guarantee specific properties.

Care and Maintenance

To clean solid grade laminate surfaces, simply wipe with a soft damp cloth and mild detergent; then rinse thoroughly with warm water and wipe dry. For stubborn stains, use an all-purpose cleaner, with a damp cloth; then rinse thoroughly with warm water and wipe dry.

For really tough stains, create a paste composed of baking soda and water. Using a soft brush, scrub gently in a circular motion – 10 to 20 strokes should remove most stains; then rinse thoroughly with warm water and wipe dry. Keep in mind that excessive scrubbing can dull or damage the finish.

Installation

Generally, the principles applicable to the installation of decorative laminate work will also apply to the installation of **Arborite®** Solid Grade laminate.

Solid Grade **Arborite®** decorative laminate can be cut, drilled and machined by standard wood-working equipment fitted with carbide cutting edges.

Surface mounted objects should be secured into the face or back of the laminate using self-tapping screws in pre-drilled holes. **IMPORTANT NOTE: D not screw into the edges of Solid Grade laminate.**

Leveling at joints should be done using shims on the underside if necessary. Do not use splines in the edges.

Metal brackets or retaining clips are recommended for securing the laminate panels together, and to abutting surfaces.

To secure counters to cabinets and provide liquid proof butt joints, a two part epoxy or silicone sealant can be used.

The following detailed drawings indicate the basic principles for installing **Arborite®** Solid Grade decorative laminate.

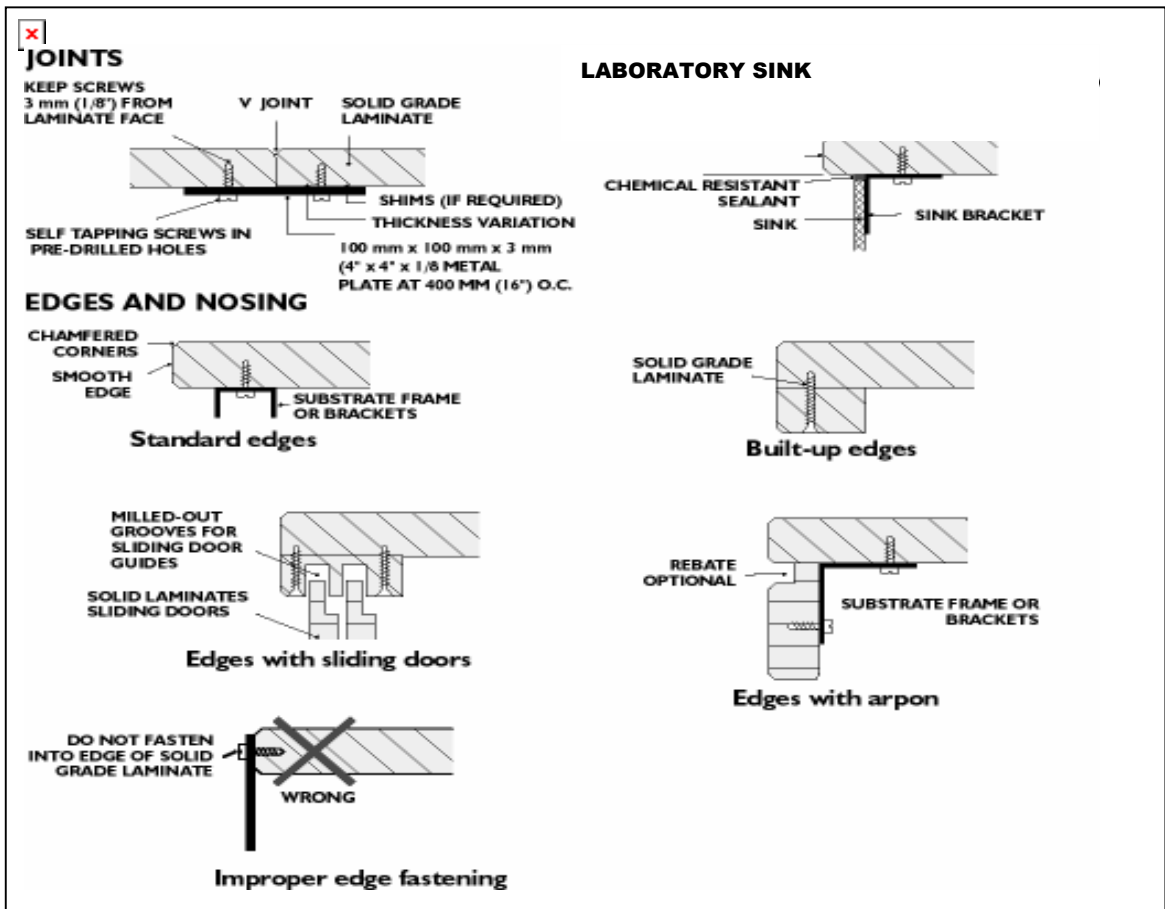



INTERSECTIONS

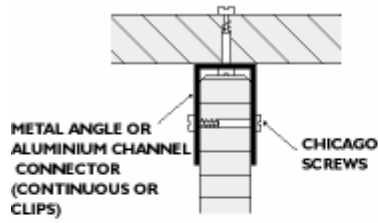

Tee intersection

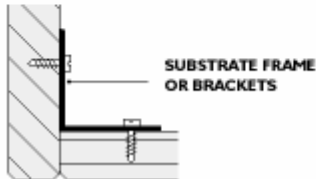

Outside corner

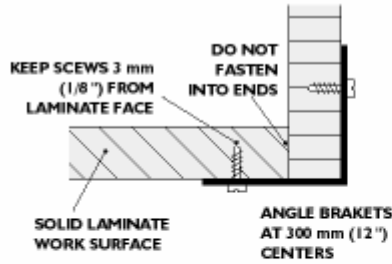

Backsplashes

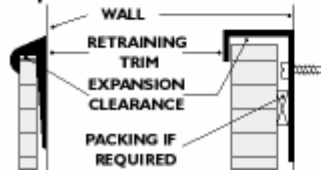

HEATING ENCLOSURE, WINDOW SILL

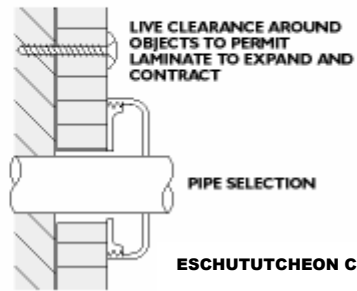
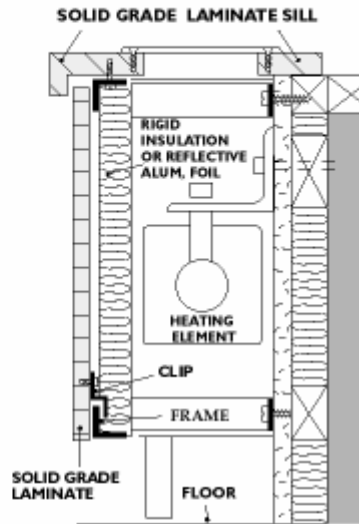

Pass-thru object

SPECIALTY PRODUCT - CANDYSTRIPE DECORATIVE LAMINATE

Candystripe is a multi-layered solid grade laminate of alternating colored and black lines.

Surface colors available include the complete Arborite® standard color collection, and the alternating colored lines are available in Arborite's standard solid color range.

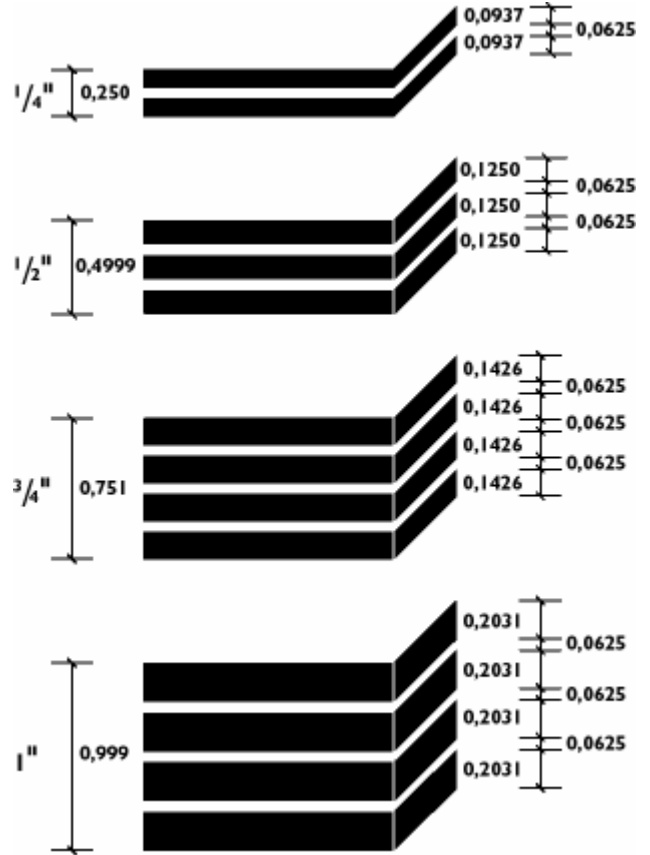

Available Surface Textures for Arborite® Candystripe Laminate

- 1) *Cashmere* – a fine, matte texture with a slight sheen
- 2) *Diamond* – a fine beaded texture which minimizes smudges, finger marks and offers optimum scratch resistance
- 3) *Gloss* – a flat texture with a high sheen
- 4) *Laqwood* – a slightly embossed woodgrain texture
- 5) *Velvatex* – a smooth furniture finish texture

Standard Panel Sizes for Arborite® Candystripe Laminates

IMPERIAL MEASURE (FEET)	METRIC MEASURE (MM)
4' x 8'	1220 mm x 2440 mm
4' x 10'	1220 mm x 3050 mm
5' x 8'	1525 mm x 2440 mm
5' x 10'	1525 mm x 3050 mm
5' x 12'	1525 mm x 3660 mm

* Gloss Surface Texture is only available in 4' x 8', 4' x 10', 5' x 12' (guaranteed good one side only)

Warranty

Arborite, division of ITW Canada, warrants that, under normal use and service, the material and workmanship of its products shall conform to the standards set forth on the applicable technical data sheets for a period of twelve (12) months from the date of sale to the first consumer purchaser. Dealers and distributors are provided with the technical data sheets which contain specific standards of performance for the products. In the event that an **Arborite** product does not perform as warranted, the first purchaser's sole remedy shall be limited to repair or replacement of all or any part of the product which is defective, at the manufacturer's sole discretion.

This warranty applies only to product :

1. In its original installation; and
2. Purchased by the first consumer purchaser.

This warranty is not transferable, and expires upon resale or transfer by the first consumer purchaser.

This warranty shall not apply to defects or damage arising from any of the following :

1. Accidents, abuse or misuse;
2. Exposure to extreme temperature;
3. Improper fabrication or installation; or
4. Improper maintenance.

NO OTHER WARRANTIES, EXPRESS OR IMPLIED, ARE MADE. UNDER NO CIRCUMSTANCES SHALL THE MANUFACTURER BE LIABLE FOR ANY LOSS OR DAMAGE ARISING FROM THE PURCHASE, USE OR INABILITY TO USE THIS PRODUCT, OR FOR ANY SPECIAL, INDIRECT, INCIDENTAL, OR CONSEQUENTIAL DAMAGES. NO FABRICATOR, INSTALLER, DEALER, AGENT OR EMPLOYEE OF ARBORITE, A DIVISION OF ITW CANADA, HAS THE AUTHORITY TO MODIFY THE OBLIGATIONS OR LIMITATION OF THIS WARRANTY.

This warranty gives you specific legal rights, and you may also have other rights which vary from state to state; therefore, some of the limitations stated above may not apply to you. It is to your benefit to save your documentation upon purchase of a product.



CALL TOLL FREE 888-231-9333 FAX TOLL FREE 800-408-0330

HOME ABOUT NEWS LINKS POLICIES SUPPORT CONTACT

your cart is empty

MY ACCOUNT

Quick Search

- ALCOVE PAKS
- DOOR HARDWARE KITS
- DOOR PULLS
- PANEL PAKS
- PILASTER PAKS
- URINAL SCREEN PAKS
- ALCOVE CLIPS
- DOOR HOOKS & DOOR STOPS
- FASTENERS
- HEADRAIL & HEADRAIL PARTS
- HINGES & HINGE PARTS
- LATCHES
- PAPER ROLL HOLDERS
- PILASTER ANCHOR PAKS/PARTS
- PILASTER SHOES
- STRIKE & KEEPERS
- U BRACKETS
- URINAL SCREEN BRACKETS
- WALL BRACKETS
- FLANGES

Welcome to Jacknob's Online Quality Toilet Partition Hardware

Featured Products



5020 - Latch Slide Surface Mounted

Chrome Plated Zamak

price: **\$5.00**



5110 - Strike & Keeper Inswing 41-I

Chrome Plated Zamak

price: **\$7.70**



5400 - Door Pull 3-1/2 Inch Centers

Chrome Plated Zamak

price: **\$3.10**



**Sale Limited Time Only!
Up to 45% Off**

Paper Roll Holders

SOLID PHENOLIC TOILET PARTITIONS

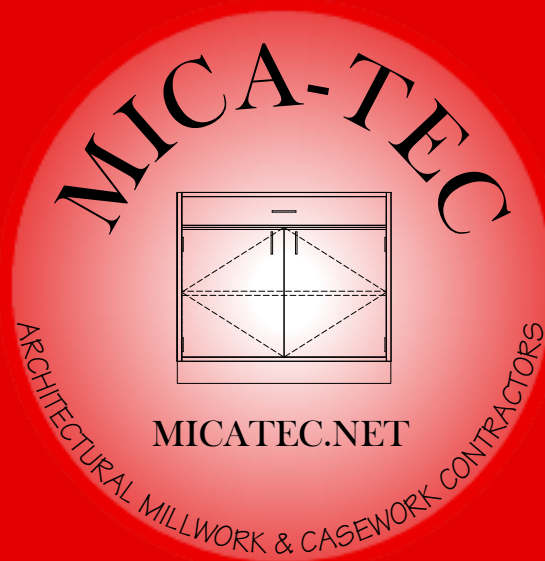

586-758-4404 FAX 586-758-3702
21325 HOVER RD.
WARREN MI. 48089

VISIT US ON THE WEB www.micatec.net